

B[®] MSS-SP-83 UNIONS - THREADED & SOCKET WELD

BONNEY FORGE

CLASS 3000

CLASS 6000

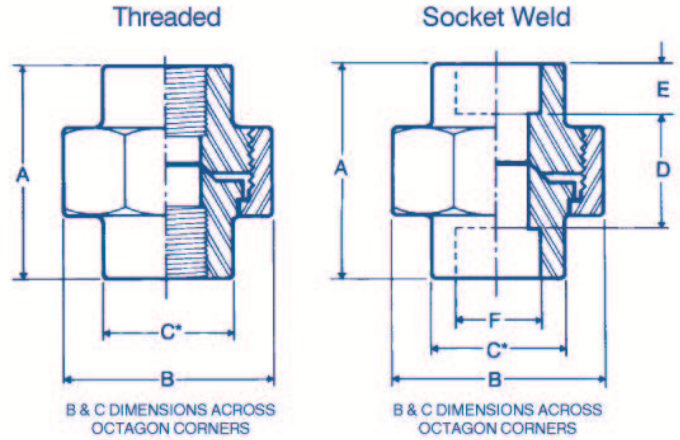
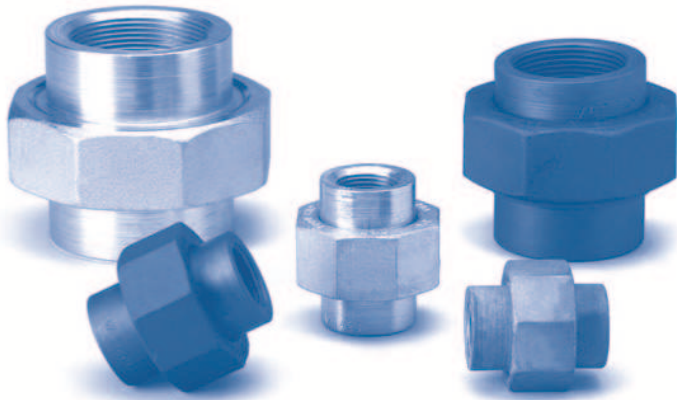

* "C" dimension is across octagon corners or a diameter as applicable. The 2 1/2" and 3" 3000 and 2" 6000 sizes have octagonal male and female ends; the other sizes are round.

CLASS 3000											
DIMENSIONS (inches)											
NOMINAL PIPE SIZE	1/0	1/4	3/8	1/2	3/4	1	1 1/4	1 1/2	2	2 1/2	3
A	1 11/16	1 11/16	1 27/32	2	2 5/16	2 7/16	2 7/8	3	3 1/2	4 1/4	4 7/16
B	1 31/64	1 31/64	1 11/16	1 15/16	2 3/8	2 25/32	3 23/64	3 23/32	4 27/64	5 15/64	6 5/32
C	53/64	53/64	1	1 3/16	1 15/32	1 25/32	2 7/32	2 35/64	3 1/16	3 9/16	4 9/32
D	25/32	25/32	31/32	1 3/32	1 5/32	1 3/8	1 45/64	1 7/8	2 1/16	2 3/8	2 7/16
E	7/16	7/16	7/16	7/16	9/16	9/16	9/16	9/16	11/16	7/8	1
F	.420	.555	.690	.855	1.065	1.330	1.675	1.915	2.406	2.906	3.535
WEIGHT PER UNION (pounds)											
	.38	.36	.50	.695	1.175	1.64	2.59	3.41	5.12	8.75	12.625

CLASS 6000											
DIMENSIONS (inches)											
NOMINAL PIPE SIZE	1/8	1/4	3/8	1/2	3/4	1	1 1/4	1 1/2	2		
A	1 11/16	1 27/32	2	2 5/16	2 7/16	2 7/8	3	3 1/2	4 1/8		
B	1 31/64	1 11/16	1 15/16	2 3/8	2 25/32	3 23/64	3 23/32	4 27/64	5 15/64		
C	53/64	1	1 3/16	1 15/32	1 25/32	2 7/32	2 35/64	3 1/16	3 9/16		
D	25/32	31/32	1 3/32	1 5/32	1 3/8	1 45/64	1 7/8	2 1/16	2 3/8		
E	7/16	7/16	7/16	9/16	9/16	9/16	9/16	11/16	7/8		
F	.420	.555	.690	.855	1.065	1.330	1.675	1.915	2.406		
WEIGHT PER UNION (pounds)											
	.5	.56	.75	1.25	1.75	3	3.75	6.0	10.5		

B[®] THREADED PLUGS & BUSHINGS

BONNEY FORGE

CLASS 3000/6000

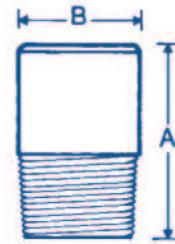
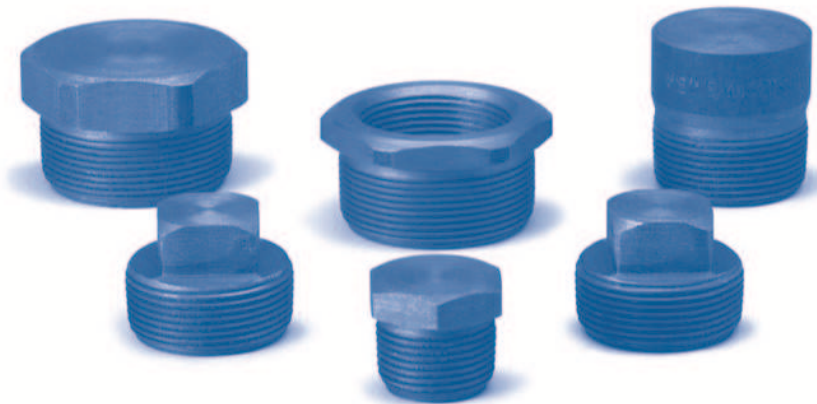

Round Head Plug

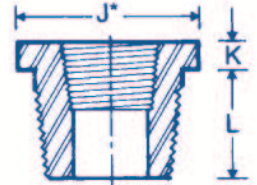

Hexagon Bushing

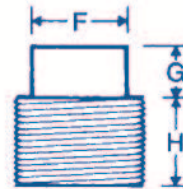

Square Head Plug

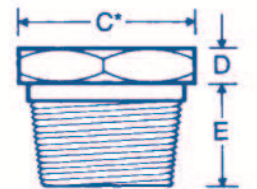

Hexagon Plug



Flush Bushing

DIMENSIONS (inches)												
NOMINAL PIPE SIZE	1/8	1/4	3/8	1/2	3/4	1	1 1/4	1 1/2	2	2 1/2	3	4
A	1 3/8	1 5/8	1 5/8	1 3/4	1 3/4	2	2	2	2 1/2	2 3/4	2 3/4	3
B	13/32	17/32	11/16	27/32	11/16	15/16	111/16	129/32	23/8	27/8	3 1/2	4 1/2
C *	7/16	5/8	11/16	7/8	11/16	17/16	113/16	2	2 1/2	3	3 3/4	4 5/8
D	1/4	1/4	5/16	5/16	3/8	3/8	9/16	5/8	11/16	3/4	13/16	1 1/4
E	7/16	1/2	9/16	11/16	3/4	27/32	7/8	15/16	1	1 1/4	1 9/16	1 21/32
F	9/32	3/8	7/16	9/16	5/8	13/16	15/16	1 1/8	1 5/16	1 1/2	1 11/16	2 1/2
G	1/4	1/4	5/16	3/8	7/16	1/2	9/16	5/8	11/16	3/4	13/16	1 1/4
H	3/8	7/16	1/2	9/16	5/8	3/4	13/16	13/16	7/8	1 1/16	1 1/8	1 3/8
J		5/8	11/16	7/8	1 1/16	1 7/16	1 11/16	2	2 1/2	3	3 3/4	4 5/8
K		3/16	3/16	3/16	1/4	1/4	3/8	3/8	3/8	1/2	13/16	1 1/4
L		1/2	9/16	11/16	3/4	27/32	7/8	15/16	1	1 1/4	1 9/16	1 21/32
M		7/16	1/2	9/16	5/8	3/4	13/16	13/16	7/8	1 1/16	1 1/8	1 1/4
N	3/8	7/16	1/2	9/16	5/8	3/4	13/16	13/16	7/8	1 1/16	1 1/8	1 1/4
WEIGHT (pounds)												
ROUND HEAD PUGS	.125	.125	.188	.250	.375	.750	1.125	1.563	3.00	4.75	7.62	12.87
HEXAGON PLUGS	.063	.063	.125	.188	.313	.500	1.125	1.375	2.25	3.87	5.87	13.00
SQUARE HEAD PLUGS	.016	.031	.063	.125	.188	.313	.563	.875	1.50	2.25	2.87	7.18
HEXAGON BUSHINGS		.063	.063	.063	.125	.188	.375	.688	1.62	2.37	3.50	8.31
FLUSH BUSHINGS		.063	.063	.063	.125	.125	.125	.188	.37	.62	1.00	2.00

* Dimension J for Hex Head Bushing and dimension C for Hex Head Plug are the same.

B[®] SOCKET WELD REDUCERS INSERTS (MSS-SP79)

BONNEY FORGE

CLASS 3000

CLASS 6000

CLASS 9000



TYPE 1

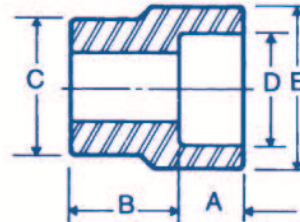

TYPE 2

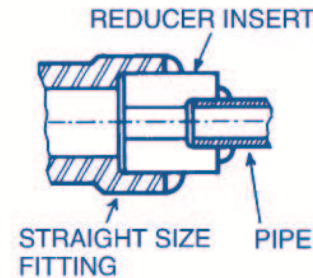
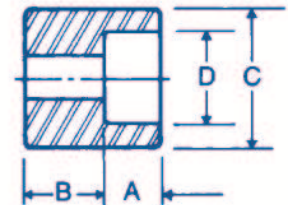

NOMINAL PIPE SIZE	CLASS 3000						CLASS 6000			CLASS 9000				
	C	D	Ftg. Type	A	B	E	Ftg. Type	A	B	E	Ftg. Type	A	B	E
3/8 x 1/4	.675	.555	1	7/16	3/4	15/16	1	7/16	7/8	1				
1/2 x 3/8	.850	.690	1	7/16	13/16	1 1/16	1	7/16	15/16	1 3/16				
1/2 x 1/4	.850	.555	1	7/16	13/16	15/16	1	7/16	7/8	1				
3/4 x 1/2	1.060	.855	1	7/16	7/8	15/16	1	7/16	1 1/16	1 3/8	1	7/16	1 3/16	1 3/4
3/4 x 3/8	1.060	.690	2	7/16	5/8	-	1	7/16	7/8	1 3/16				
3/4 x 1/4	1.060	.555	2	3/8	1 1/16	-	2	3/8	7/8	-				
1 x 3/4	1.325	1.065	1	9/16	15/16	1 1/2	1	9/16	1 1/8	1 11/16	1	9/16	1 1/4	2
1 x 1/2	1.325	.855	2	1/2	5/8	-	1	7/16	1 1/8	1 3/8	1	7/16	1 1/8	1 3/4
1 x 3/8	1.325	.690	2	7/16	1 1/16	-	2	1/2	7/8	-				
1 x 1/4	1.325	.555	2	3/8	3/4	-	2	3/8	15/16	-				
1 1/4 x 1	1.670	1.330	1	9/16	1	1 7/8	1	9/16	1 3/16	2	1	9/16	1 3/8	2 3/8
1 1/4 x 3/4	1.670	1.065	2	9/16	1 1/16	-	2	9/16	1 3/16	-	1	9/16	1 3/16	2
1 1/4 x 1/2	1.670	.855	2	1/2	3/4	-	2	1/2	7/8	-	2	1/2	7/8	-
1 1/4 x 3/8	1.670	.690	2	7/16	1 3/16	-	2	7/16	15/16	-				
1 1/4 x 1/4	1.670	.555	2	3/8	7/8	-	2	3/8	1	-				
1 1/2 x 1 1/4	1.910	1.675	1	9/16	1 1/8	2 1/4	1	9/16	1 3/8	2 3/8	1	9/16	1 5/8	2 3/4
1 1/2 x 1	1.910	1.330	2	5/8	1 1/16	-	1	9/16	1 3/16	2	1	9/16	1 3/8	2 3/8
1 1/2 x 3/4	1.910	1.065	2	9/16	3/4	-	2	9/16	1	-	2	9/16	1	-
1 1/2 x 1/2	1.910	.855	2	1/2	1 3/16	-	2	1/2	1 1/16	-	2	9/16	1	-
1 1/2 x 3/8	1.910	.690	2	7/16	7/8	-	2	7/16	1 1/8	-				
2 x 1 1/2	2.385	1.915	1	9/16	1 1/4	2 1/2	1	9/16	1 7/8	2 11/16	1	9/16	2 1/16	3
2 x 1 1/4	2.385	1.675	2	1 1/16	1 3/16	-	2	7/8	15/16	-	1	9/16	2	2 3/4
2 x 1	2.385	1.330	2	5/8	7/8	-	2	1 3/16	1	-	2	1 3/16	1	-
2 x 3/4	2.385	1.065	2	9/16	15/16	-	2	3/4	1 1/16	-	2	3/4	1 1/16	-
2 x 1/2	2.385	.855	2	1/2	1	-	2	1 1/16	1 1/8	-	2	1 1/16	1 1/8	-

Note: Socket Weld Reducer Inserts comply fully with MSS-SP-79

B[®] THREADED COUPLINGS, REDUCERS & CAPS

BONNEY FORGE

CLASS 3000

CLASS 6000

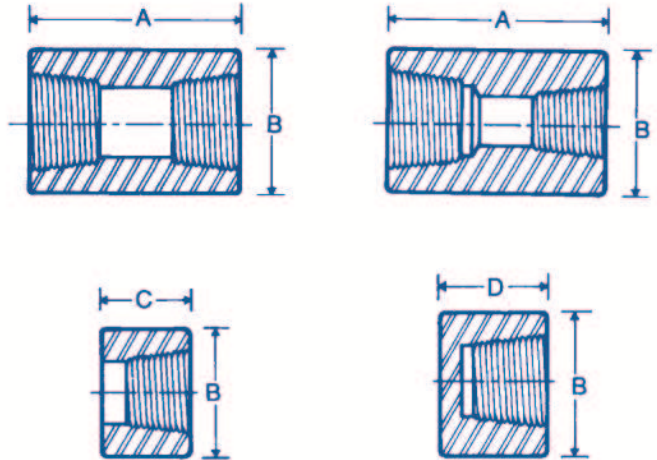
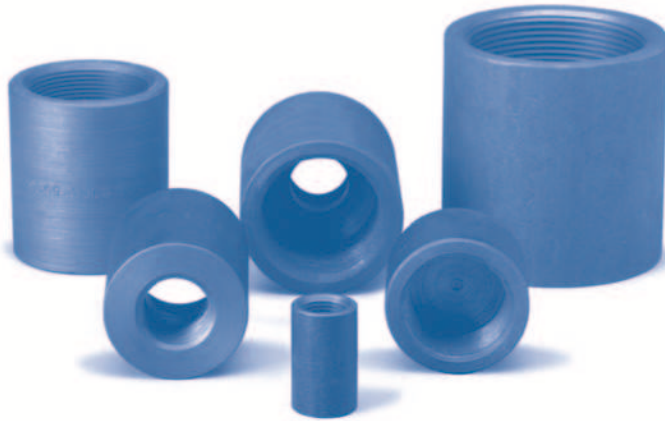

CLASS 3000												
DIMENSIONS (inches)												
NOMINAL PIPE SIZE	1/8	1/4	3/8	1/2	3/4	1	1 1/4	1 1/2	2	2 1/2	3	4
A	1 1/4	1 3/8	1 1/2	1 7/8	2	2 3/8	2 5/8	3 1/8	3 3/8	3 5/8	4 1/4	4 3/4
B	3/4	3/4	7/8	1 1/8	1 3/8	1 3/4	2 1/4	2 1/2	3	3 5/8	4 1/4	5 1/2
C	5/8	1 1/16	3/4	15/16	1	1 3/16	1 5/16	1 9/16	1 11/16	1 13/16	2 1/8	2 3/8
D	15/16	1	1	1 1/4	1 7/16	1 5/8	1 3/4	1 3/4	1 7/8	2 3/8	2 9/16	2 11/16
WEIGHT (pounds)												
COUPLING	.125	.125	.25	.25	.438	.625	1.563	2.188	3.125	4	6.75	16.75
REDUCER	.125	.125	.25	.25	.438	.625	1.563	2.188	3.125	4	6.75	16.75
HALF COUPLING	.063	.063	.188	.188	.25	.313	.75	1.125	1.563	2	3.375	8.375
PIPE CAP	.031	.063	.125	.25	.313	.50	1	1.625	3.125	5	8.50	14

CLASS 6000												
DIMENSIONS (inches)												
NOMINAL PIPE SIZE	1/8	1/4	3/8	1/2	3/4	1	1 1/4	1 1/2	2	2 1/2	3	4
A	1 1/4	1 3/8	1 1/2	1 7/8	2	2 3/8	2 5/8	3 1/8	3 3/8	3 5/8	4 1/4	4 3/4
B	7/8	1	1 1/4	1 1/2	1 3/4	2 1/4	2 1/2	3	3 5/8	4 1/4	5	6 1/4
C	5/8	1 1/16	3/4	15/16	1	1 3/16	1 5/16	1 9/16	1 11/16	1 13/16	2 1/8	2 3/8
D	1	1 1/16	1 1/16	1 5/16	1 1/2	1 11/16	1 13/16	1 7/8	2	2 1/2	2 11/16	2 15/16
WEIGHT (pounds)												
COUPLING	.188	.188	.25	.50	1	2.125	2.375	4.375	7.75	10.75	13.50	24.50
REDUCER	.188	.188	.25	.50	1	2.125	2.375	4.375	7.75	10.75	13.50	24.50
HALF COUPLING	.094	.094	.125	.25	.50	1.063	1.188	2.188	3.875	5.375	6.75	12.25
PIPE CAP	.125	.125	.188	.313	.438	.75	1.313	1.688	3.25			

B[®] SOCKET WELD COUPLINGS, REDUCERS & CAPS

BONNEY FORGE

CLASS 3000

CLASS 6000

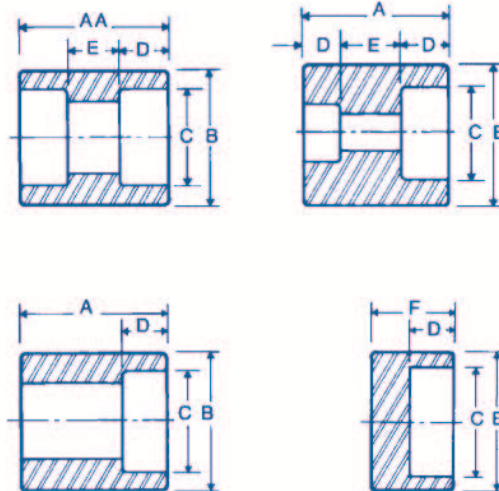

DIMENSIONS (Inches)													
CLASS 3000	NOMINAL PIPE SIZE	1/8	1/4	3/8	1/2	3/4	1	1 1/4	1 1/2	2	2 1/2	3	4
	A	1 1/8	1 1/8	1 1/8	1 3/8	1 1/2	1 3/4	1 7/8	2	2 1/2	2 1/2	2 3/4	3
	AA	1 1/32	1 1/32	1 1/32	1 9/64	1 13/32	1 33/64	1 33/64	1 33/64	2 1/64	2 1/64	2 1/64	2 17/64
	B	3/4	7/8	1 1/16	1 1/4	1 1/2	1 13/16	2 1/4	2 1/2	3	3 5/8	4 5/16	5 1/2
	C	.420	.555	.690	.855	1.065	1.330	1.675	1.915	2.406	2.906	3.535	4.545
	D	7/16	7/16	7/16	1/2	9/16	5/8	11/16	3/4	7/8	7/8	1	1 1/8
	F	1/4	1/4	1/4	3/8	3/8	1/2	1/2	1/2	3/4	3/4	3/4	3/4
	11/16	3/4	3/4	7/8	1	1 1/16	1 3/16	1 1/4	1 1/2	1 9/16	1 13/16	2 1/16	
WEIGHT (pounds)													
COUPLING	.125	.125	.125	.188	.313	.563	.813	1	2	2.625	3.875	6.625	
REDUCER	.125	.125	.125	.188	.313	.563	.813	1	2	2.625	3.875	6.625	
HALF COUPLING	.125	.125	.125	.188	.313	.563	.813	1	2	2.625	3.875	6.625	
PIPE CAP	.063	.063	.125	.188	.313	.563	.813	1.125	1.688	3	3.625	6.688	

DIMENSIONS (Inches)													
CLASS 6000	NOMINAL PIPE SIZE		1/4	3/8	1/2	3/4	1	1 1/4	1 1/2	2	2 1/2	3	4
	A		1 1/8	1 1/8	1 3/8	1 1/2	1 3/4	1 7/8	2	2 1/2	2 1/2	2 3/4	3
	AA		1 1/8	1 1/8	1 5/32	1 13/32	1 33/64	1 33/64	1 33/64	2 1/64	2 1/64	2 1/64	2 17/64
	B		1 1/16	1 5/16	1 1/2	1 3/4	2 1/4	2 1/2	3	3 5/8	4 1/4	5	6 1/4
	C		.555	.690	.855	1.065	1.330	1.675	1.915	2.406	2.906	3.535	4.545
	D		7/16	7/16	1/2	9/16	5/8	11/16	3/4	7/8	7/8	1	1 1/8
	F		1/4	1/4	3/8	3/8	1/2	1/2	1/2	3/4	3/4	3/4	3/4
		15/16	15/16	1	1 1/16	1 1/4	1 5/16	1 3/8	1 5/8	1 11/16	1 15/16	2 5/16	
WEIGHT (pounds)													
COUPLING				.375	.563	1	1.438	2	3.875	5.50	6.625	13.125	
REDUCER				.375	.563	1	1.438	2	3.875	5.50	6.625	13.125	
HALF COUPLING				.375	.563	1	1.438	2	3.875	5.50	6.625	13.125	
PIPE CAP				.375	.50	1.125	1.125	2.25	3.50	5.625	6	13.50	

B[®] QUIKLEG90[™] - SOCKET WELD - THREADED - BUTT WELD

BONNEY FORGE

CLASS 3000

CLASS 6000

STD-XSTG

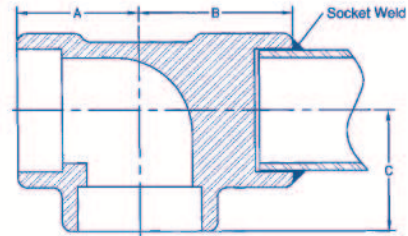
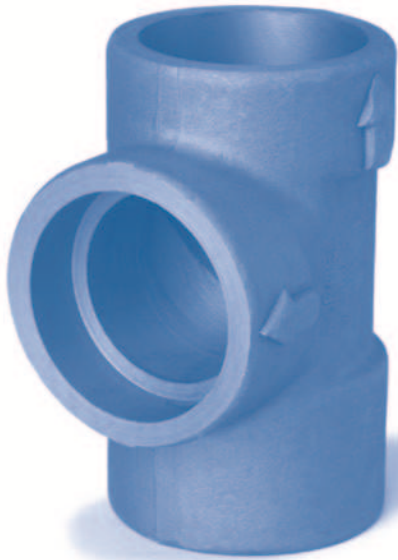

Socket Weld

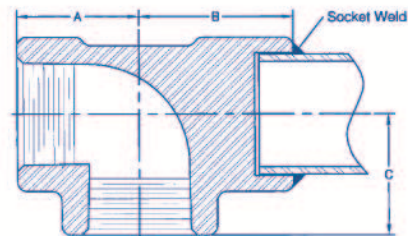

Threaded

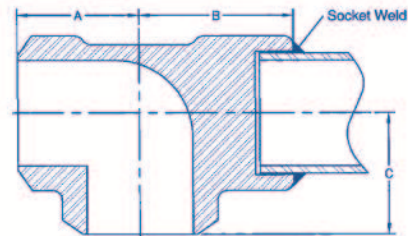

Butt Weld

CLASS 3000	DIMENSIONS (inches)	SOCKET WELD						THREADED					
	NOMINAL PIPE SIZE	1/2	3/4	1	1 1/4	1 1/2	2	1/2	3/4	1	1 1/4	1 1/2	2
	A Nominal	-	1 1/2	1 1/2	1 3/4	2	2 3/8	1 1/2	1 1/2	1 3/4	2	2 3/8	2 1/2
	B Nominal	-	1 7/8	1 7/8	2 3/16	2 1/2	3	1 7/8	1 7/8	2 3/16	2 1/2	3	3 1/8
	C Nominal	-	1 1/2	1 1/2	1 3/4	2	2 3/8	1 1/2	1 1/2	1 3/4	2	2 3/8	2 1/2

CLASS 6000	DIMENSIONS (inches)	SOCKET WELD						THREADED					
	NOMINAL PIPE SIZE	1/2	3/4	1	1 1/4	1 1/2	2	1/2	3/4	1	1 1/4	1 1/2	2
	A Nominal	-	1 1/2	1 3/4	2	2 3/8	2 1/2	1 1/2	1 3/4	2	2 3/8	2 1/2	-
	B Nominal	-	1 7/8	2 3/16	2 1/2	3	3 1/8	1 7/8	2 3/16	2 1/2	3	3 1/8	-
	C Nominal	-	1 1/2	1 3/4	2	2 3/8	2 1/2	1 1/2	1 3/4	2	2 3/8	2 1/2	-

STD-XSTG	DIMENSIONS (inches)	BUTT WELD				
	NOMINAL PIPE SIZE	2	2 1/2	3	4	
	A Nominal	2 3/8	3	3 3/8	4 3/16	
	B Nominal	3	3	3 3/8	4 3/16	
	C Nominal	2 3/8	3	3 3/8	4 3/16	

B[®] THREADED FITTINGS

BONNEY FORGE

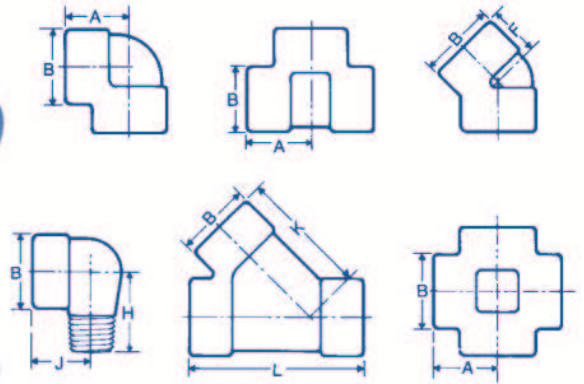

CLASS 2000

CLASS 3000

CLASS 6000

DIMENSIONS (Inches)													
NOMINAL PIPE SIZE		1/8	1/4	3/8	1/2	3/4	1	1 1/4	1 1/2	2	2 1/2	3	4
CLASS 2000	90EL TEE A		7/8	31/32	1 1/8	15/16	1 1/2	1 3/4	2	2 3/8	3	3 3/8	4 3/16
	STEL LAT B		29/32	1 1/16	1 5/16	1 9/16	1 27/32	2 7/32	2 1/2	3 1/32	3 11/16	4 5/16	5 3/4
	F		3/4	3/4	1	1 1/8	1 1/4	1 5/16	1 3/8	1 11/16	2 1/16	2 1/2	3 1/8
CLASS 2000	45EL CROSS A		7/8	31/32	1 1/8	15/16	1 1/2	1 3/4	2	2 3/8	3 1/4	3 3/4	4 1/2
	B		29/32	1 1/16	1 5/16	1 9/16	1 27/32	2 7/32	2 1/2	3 1/32	4	4 3/4	6
	F		3/4	3/4	1	1 1/8	1 1/4	1 5/16	1 3/8	1 11/16	2 1/16	2 1/2	3 1/8
WEIGHT (pounds)													
	90° ELBOW	.25	.198	.283	.500	.773	1.013	1.550	2.180	3.140	6.50	10.925	26.675
	45° ELBOW	.125	.188	.236	.435	.740	1.058	1.375	1.740	2.883	7.75	11.313	19.125
	TEE	.25	.267	.373	.613	.963	1.355	2.030	2.800	4.456	9.530	12.908	28.700
	CROSS	.50	.50	.460	.777	1.125	1.688	2.450	3.188	5.560	16.438	19.50	32.688

DIMENSIONS (Inches)													
NOMINAL PIPE SIZE		1/8	1/4	3/8	1/2	3/4	1	1 1/4	1 1/2	2	2 1/2	3	4
CLASS 3000	A	7/8	31/32	1 1/8	1 5/16	1 1/2	1 3/4	2	2 3/8	2 1/2	3 1/4	3 3/4	4 1/2
	B	29/32	1 1/16	1 5/16	1 9/16	1 27/32	2 7/32	2 1/2	3 1/32	3 11/32	4	4 3/4	6
	F	3/4	3/4	1	1 1/8	1 1/4	1 5/16	1 3/8	1 11/16	1 3/4	2 1/16	2 1/2	3 1/8
	H	1 1/4	1 1/4	1 1/2	1 5/8	1 7/8	2 1/4	2 5/8	2 15/16	3 5/16			
CLASS 3000	J	7/8	7/8	1	1 1/8	1 3/8	1 3/4	2	2 1/8	2 1/2			
	K		1 7/8	2 1/8	2 9/16	3	3 1/2	3 15/16	4 3/4	5			
	L		2 11/16	3	3 9/16	4 1/8	4 13/16	5 3/8	6 7/16	6 5/8			
	WEIGHT (pounds)												
	90° ELBOW	.236	.350	.592	.973	1.355	2.265	2.407	3.50	5.920	11.900	14.438	31.975
	45° ELBOW	.25	.290	.50	.75	1.188	1.988	2.235	3.00	4.930	7.375	13.558	19.063
	TEE	.325	.460	.753	1.270	1.830	3.025	3.620	7.040	7.550	13.125	23.100	40.000
	STREET ELBOW	.264	.242	.375	.595	1.048	1.438	2.340	3.00	5.461			
	LATERAL		.625	1.313	1.75	2.75	4.625	5.50	10.813	11.5			
	CROSS	.438	.567	.970	1.50	2.50	3.620	4.125	6.50	8.125	16.75	25.675	32

DIMENSIONS (Inches)													
NOMINAL PIPE SIZE		1/8	1/4	3/8	1/2	3/4	1	1 1/4	1 1/2	2	2 1/2	3	4
CLASS 6000	90EL TEE A	31/32	1 1/8	1 5/16	1 1/2	1 3/4	2	2 3/8	2 1/2	3 1/4	3 3/4	4 3/16	4 1/2
	STEL LAT B	1 1/16	1 5/16	1 9/16	1 27/32	2 7/32	2 1/2	3 1/32	3 11/32	4	4 3/4	5 3/4	6
	F	3/4	1	1 1/8	1 1/4	1 5/16	1 3/8	1 11/16	1 3/4	2 1/16	2 1/2	3 1/8	3 1/8
	H	1 1/4	1 1/2	1 5/8	1 7/8	2 1/4	2 5/8	2 15/16	3 5/16				
CLASS 6000	45EL CROSS A	31/32	1 1/8	1 5/16	1 1/2	1 3/4	2	2 3/8	2 1/2	3 1/4	3 3/4	4 1/2	4 1/2
	B	1 1/16	1 5/16	1 9/16	1 27/32	2 7/32	2 1/2	3 1/32	3 11/32	4	4 3/4	6	6
	F	3/4	1	1 1/8	1 1/4	1 5/16	1 3/8	1 11/16	1 3/4	2 1/16	2 1/2	3 1/8	3 1/8
CLASS 6000	J	7/8	1	1 1/8	1 3/8	1 3/4	2	2 1/8	2 1/2				
	K			2 9/16	3	3 1/2	3 15/16	4 3/4	5				
	L			3 9/16	4 1/8	4 13/16	5 3/8	6 7/16	6 5/8				
WEIGHT (pounds)													
	90° ELBOW	.25	.625	1.023	1.625	2.625	3.50	6.75	7.50	13.438	20.875	39.050	38
	45° ELBOW	.25	.640	.50	1.438	2.188	2.785	4.688	5.75	9.50	15	30.563	29
	TEE	.50	.853	1.410	2.150	3.563	4.625	7.625	9.625	18.500	28.063	47.500	50
	STREET ELBOW		.375	.438	1	1.625	3.030	3.688	7.120				
	LATERAL			2.375	3.25	5.438	7.188	12.313	15.95				
	CROSS	.563	1.188	1.50	2.75	4.313	6.625	10.75	11.50	22.188	27.50	54	43.50

B[®] SOCKET WELD FITTINGS

BONNEY FORGE

CLASS 9000

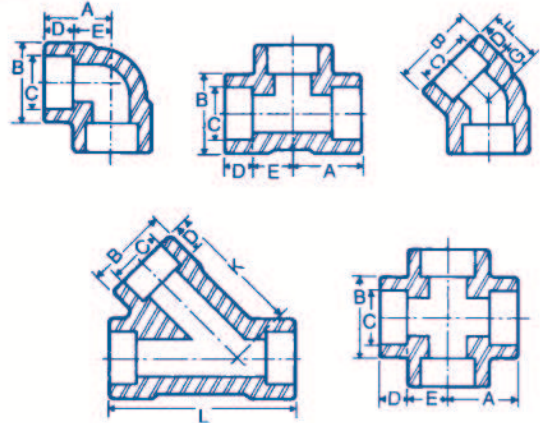
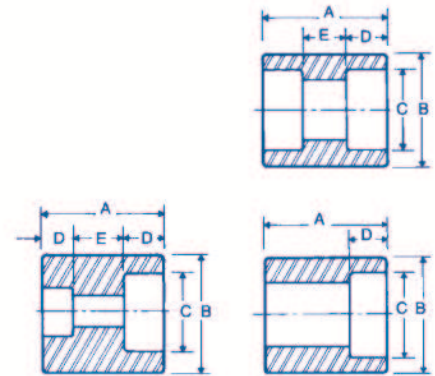
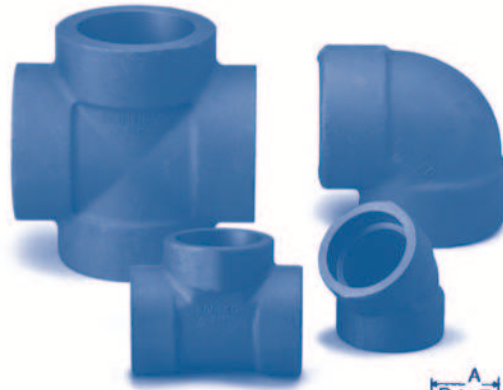

CLASS 9000 XXS BORE- 90° ELBOW						
DIMENSIONS (Inches)						
NOMINAL PIPE SIZE	1/2	3/4	1	1 1/4	1 1/2	2
A	1 1/2	1 3/4	2	2 3/8	2 1/2	3
B	1 27/32	2 7/32	2 1/2	3 1/32	3 11/32	3 11/16
(MIN.) D	3/8	1/2	1/2	1/2	1/2	5/8
E	1	1 1/8	1 1/4	1 3/8	1 1/2	2 1/8
WEIGHT (pounds)						
Weight	1.44	2.25	3.19	5.25	6.69	6.69

CLASS 9000 XXS BORE- TEE						
DIMENSIONS (Inches)						
NOMINAL PIPE SIZE	1/2	3/4	1	1 1/4	1 1/2	2
A	1 1/2	1 3/4	2	2 3/8	2 1/2	3
B	1 27/32	2 7/32	2 1/2	3 1/32	3 11/32	3 11/16
(MIN.) D	3/8	1/2	1/2	1/2	1/2	5/8
E	1	1 1/8	1 1/4	1 3/8	1 1/2	2 1/8
WEIGHT (pounds)						
Weight	2.00	3.31	3.75	6.50	7.88	8.75

CLASS 9000 XXS BORE- 45° ELBOW						
DIMENSIONS (Inches)						
NOMINAL PIPE SIZE	1/2	3/4	1	1 1/4	1 1/2	2
B	1 27/32	2 7/32	2 1/2	3 1/32	3 3/8	4
(MIN.) D	5/8	9/16	9/16	13/16	3/4	15/16
F	1 1/4	1 5/16	1 3/8	1 11/16	1 3/4	2 1/16
G	5/8	3/4	13/16	7/8	1	1 1/8
WEIGHT (pounds)						
Weight	1.31	2.06	2.50	4.31	4.81	9.62

CLASS 9000 XXS BORE- LATERAL						
DIMENSIONS (Inches)						
NOMINAL PIPE SIZE	1/2	3/4	1	1 1/4	1 1/2	2
B	1 27/32	2 7/32	2 1/2	3 1/32	3 11/32	
(MIN.) D	9/16	5/8	11/16	7/8	7/8	
K	3	3 1/2	3 15/16	4 3/4	5	
L	4 1/8	4 13/16	5 3/8	6 7/16	6 5/8	
WEIGHT (pounds)						
Weight	1.75	2.38	3.75	6.88	6.88	

DIMENSIONS C - COMMON TO ALL FITTINGS (Inches)						
NOMINAL PIPE SIZE	1/2	3/4	1	1 1/4	1 1/2	2
C	.855	1.065	1.330	1.675	1.915	2.406

CLASS 9000 XXS BORE- CROSS						
DIMENSIONS (Inches)						
NOMINAL PIPE SIZE	1/2	3/4	1	1 1/4	1 1/2	2
A	1 1/2	1 3/4	2	2 3/8	2 1/2	3 1/4
B	1 27/32	2 7/32	2 1/2	3 1/32	3 11/32	4
(MIN.) D	1/2	5/8	3/4	1	1	1 1/8
E	1	1 1/8	1 1/4	1 3/8	1 1/2	2 1/8
WEIGHT (pounds)						
Weight	2.50	4.12	4.12	5.12	9.44	22.19

CLASS 9000 XXS BORE- COUPLINGS- REDUCERS- HALF COUPLING						
DIMENSIONS (Inches)						
NOMINAL PIPE SIZE	1/2	3/4	1	1 1/4	1 1/2	2
A	1 3/8	1 1/2	1 3/4	1 7/8	2	2 1/2
B	1 13/16	2	2 3/8	2 3/4	3 1/16	3 5/8
(MIN.) D	1/2	9/16	5/8	11/16	3/4	7/8
E	3/8	3/8	1/2	1/2	1/2	3/4
F						
WEIGHT (pounds)						
Coupling	.75	1.06	1.69	2.22	2.81	4.66
Reducer	.75	1.06	1.69	2.22	2.81	4.66
Half Coupling	.88	1.16	1.88	2.50	3.25	5.38

B SOCKET WELD FITTINGS

BONNEY FORGE

CLASS 3000

CLASS 6000

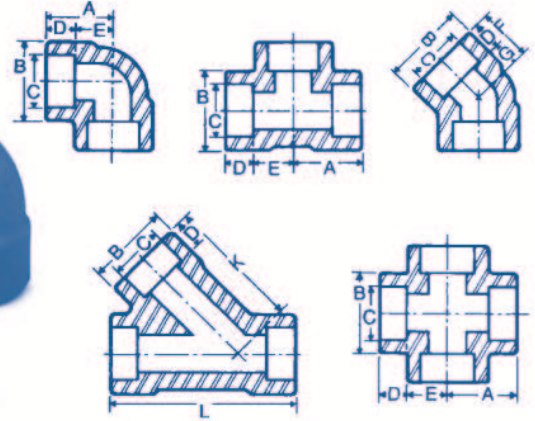
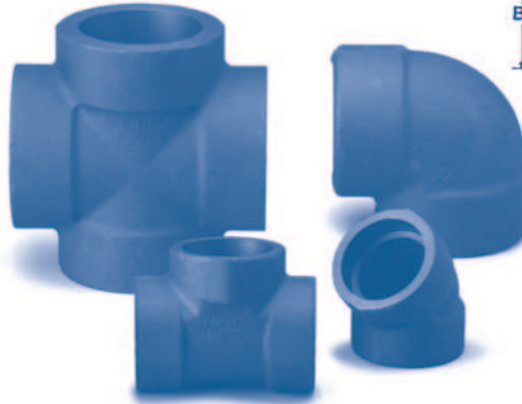

CLASS 3000 - Schedule 40 Bore													
DIMENSIONS (Inches)													
NOMINAL PIPE SIZE		1/8	1/4	3/8	1/2	3/4	1	1 1/4	1 1/2	2	2 1/2	3	4
90° EL TEE LAT	A	7/8	7/8	31/32	1 1/8	15/16	1 1/2	1 3/4	2	2 3/8	3	3 3/8	43/16
	B	29/32	29/32	1 1/16	15/16	19/16	127/32	27/32	2 1/2	3 1/32	3 11/16	45/16	5 3/4
	(MIN.) D	3/8	3/8	3/8	3/8	1/2	1/2	1/2	1/2	5/8	5/8	5/8	3/4
45° EL CROSS	A	7/8	7/8	31/32	1 1/8	15/16	1 1/2	1 3/4	2	2 3/8	3 1/4	3 3/4	4 1/2
	B	29/32	29/32	1 1/16	15/16	19/16	127/32	27/32	2 1/2	3 1/32	4	4 3/4	6
	(MIN.) D	3/8	3/8	3/8	3/8	1/2	1/2	1/2	1/2	5/8	5/8	5/8	3/4
	E	7/16	7/16	17/32	5/8	3/4	7/8	11/16	1 1/4	1 1/2	15/8	2 1/4	2 5/8
	F	3/4	3/4	3/4	1	1 1/8	1 1/4	15/16	1 3/8	1 11/16	2 1/16	2 1/2	3 1/8
	G	5/16	5/16	5/16	7/16	1/2	9/16	11/16	13/16	1	1 1/8	1 1/4	1 5/8
	H	1 1/4	1 1/4	1 1/2	1 5/8	1 7/8	2 1/4	2 5/8	2 15/16	3 5/16			
	J	7/8	7/8	1	1 1/8	1 3/8	1 3/4	2	2 1/8	2 1/2			
	K			1 7/8	2 1/8	2 9/16	3	3 1/2	3 15/16	4 3/4			
	L			2 11/16	3	3 9/16	4 1/8	4 13/16	5 3/8	6 7/16			
DIMENSIONS C (Common to all fittings)		.420	.555	.690	.855	1.065	1.330	1.675	1.915	2.406	2.906	3.535	4.545
WEIGHT (pounds)													
	90° ELBOW	.125	.183	.270	.460	.698	.987	1.480	2.088	3.125	6.340	10.867	25.00
	45° ELBOW	.125	.198	.210	.440	.673	.935	1.365	1.63	2.71	6.75	10.50	18.188
	TEE	.25	.25	.345	.540	.925	1.307	2.00	2.640	4.070	8.75	12.50	27.80
	STREET ELBOW	.25	.25	.375	.50	.875	1.438	2.25	3.00	5.188			
	LATERAL		.25	.625	1.00	1.500	2.375	3.75	4.125	6.285			
	CROSS	.25	.25	.375	.813	1.125	1.550	2.25	3.063	5.125	18.00	23.00	40.00

CLASS 6000 - Schedule 160 Bore													
DIMENSIONS (Inches)													
NOMINAL PIPE SIZE		1/8	1/4	3/8	1/2	3/4	1	1 1/4	1 1/2	2	2 1/2	3	4
A	A	7/8	31/32	1 1/8	15/16	1 1/2	1 3/4	2	2 3/8	2 1/2	3 1/4	3 3/4	4 1/2
	B	29/32	1 1/16	15/16	19/16	127/32	27/32	2 1/2	3 1/32	3 11/32	4	4 3/4	6
	(MIN.) D	3/8	3/8	3/8	3/8	1/2	1/2	1/2	1/2	5/8	5/8	5/8	3/4
E	E	7/16	17/32	5/8	3/4	7/8	11/16	1 1/4	1 1/2	15/8	2 1/4	2 1/2	2 3/4
	F	3/4	3/4	1	1 1/8	1 1/4	15/16	1 3/8	1 11/16	13/4	2 1/16	2 1/2	3 1/8
	G	5/16	5/16	7/16	1/2	9/16	11/16	13/16	1	1 1/8	1 1/4	1 3/8	1 5/8
H	H	1 1/4	1 1/2	1 5/8	1 7/8	2 1/4	2 5/8	2 15/16	3 5/16				
	J	7/8	1	1 1/8	1 3/8	1 3/4	2	2 1/8	2 1/2				
	K			2 1/8	2 9/16	3	3 1/2	3 15/16	4 3/4				
L	L			3	3 9/16	4 1/8	4 13/16	5 3/8	6 7/16				
									5				
									6 5/8				
DIMENSIONS C (Common to all fittings)		.420	.555	.690	.855	1.065	1.330	1.675	1.915	2.406	2.906	3.535	4.545
WEIGHT (pounds)													
	90° ELBOW				.938	1.440	2.348	3.188	5.25	6.660	11.875	19.25	32.70
	45° ELBOW				.875	1.313	1.913	2.27	4.313	4.813	9.625	14.25	27.25
	TEE				1.375	2.00	3.313	3.75	7.480	8.240	16.625	23.50	33.00
	STREET ELBOW		.375	.438	1.00	1.625	2.50	3.688	6.438				
	LATERAL				2.00	3.063	5.125	6.25	11.938	12.5			
	CROSS				1.50	2.50	3.460	5.25	8.75	9.438	20.25	27.00	39.00